

PZ24-13000001
06/18/2024

PZ24-13000001
04/03/2024

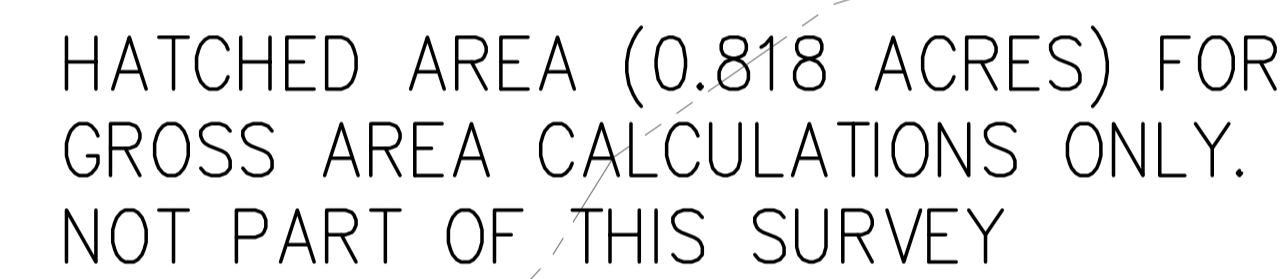

SEE SHEET 1 FOR LEGAL DESCRIPTION
SEE SHEET 2 FOR BOUNDARY TEXT
SEE SHEET 3 FOR ELEVATIONS (SCALE 1"=80')

LEGEND

A/C - AIR CONDITIONER
L - ARC LENGTH
ALUM. - ALUMINUM
B.E. - BUFFER EASEMENT
C.O. - CLEANOUT
CLF - CHAIN LINK FENCE
CONC. - CONCRETE
COV. COVERED
D.E. - DRAINAGE EASEMENT
ELEC. - ELECTRIC
ELEV. - ELEVATION
EQUIP. - EQUIPMENT
EXIST. - EASEMENT
EXIST. - EXISTING
F.O.M. - FIBER-OPTIC MARKER
F.P.L. - FLORIDA POWER & LIGHT
FIN. - FINISHED
FLR. - FLOOR
FND. - FUND
I.R./CAP - IRON ROD & CAP
INV. - INVERT
IRR. - IRRIGATION
L.A.E. - LIMITED ACCESS EASEMENT
O/S - BUILDING OFFSET
O.R.B. - OFFICIAL RECORD BOOK
P.B. - PLAT BOOK
P.C.B. - PALM BEACH COUNTY RECORD
P.B. BEGINNING
P.O.C. - POINT OF COMMENCEMENT
P.O.S. - AGES
P.R.M. - PERMANENT REFERENCE MONUMENT
PROP. - PROPOSED
R - RADIUS
R/W - RIGHT-OF-WAY
RGE. - RANGE
SEC - SECTION
Δ - DELTA (CENTRAL ANGLE)

SQ. FT. - SQUARE FEET
TWP. - TOWNSHIP
TYP. - TYPICAL
U.E. - UTILITY EASEMENT
W.M. - WATER METER
W.E. - WATER EASEMENT
S.E. - SANITARY EASEMENT
— LIGHT POLE
— FIRE HYDRANT
☀ - CATCH BASIN
— WATER VALVE
⊗ - SET 5/8" I.R./CAP LB 3591
Ⓢ - SANITARY MANHOLE
Ⓢ - DRAINAGE MANHOLE
Ⓢ - WOOD POWER POLE (UNLESS NOTED)
Ⓢ - CENTER LINE
— EXISTING ELEVATION
⊥ - TRAFFIC SIGN
— ELECTRICAL WIRES OVERHEAD
Ⓢ - ANCHOR
— WATER METER
Ⓢ - RP2
— GROUND LIGHT
— ELECTRIC
Ⓢ - IRRIGATION CONTROL VALVE
Ⓢ - CONCRETE POWER POLE
— FIRE DEPARTMENT CONNECTION

CAULFIELD & WHEELER, INC.
CIVIL ENGINEERING
LANDSCAPE ARCHITECTURE - SURVEYING
7900 GLADES ROAD - SUITE 100
BOCA RATON, FLORIDA 33434
PHONE (561)-392-1991 / FAX (561)-750-1452

PALM AIRE TOWNHOMES
ALTA/NSPS LAND TITLE SURVEY

TE	0000
AWN BY	0000
B./ PG.	HDS
SCALE	

DAVID P. LINDLEY
REGISTERED LAND
SURVEYOR NO. 5005
STATE OF FLORIDA
L.B. 3591

DB # 10564
T.NO.
4
4 SHEETS

PZ24-13000001
02/07/2024